

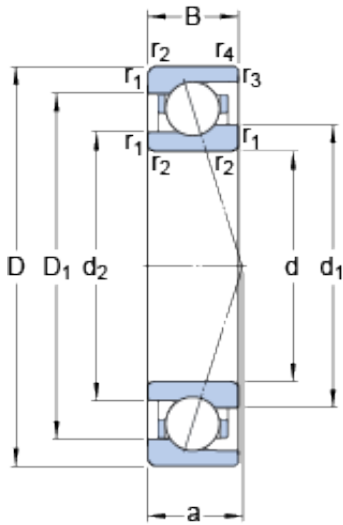

San Driveshaft Co., Ltd.



71903 CE/HCP4A Bearing 2D drawings and 3D CAD models

17 mm x 30 mm x 7 mm SKF 71903 CE/HCP4A
Interchangeable with open TAC serie Precision Bearings

Bearing No. 71903 CE/HCP4A

Size	30x17x7 mm
Bore Diameter	30 mm
Outer Diameter	17 mm
Width	7 mm
d	17 mm
D	30 mm
B	7 mm
d ₁	21.1 mm
d ₂	20.1 mm
D ₁	25.9 mm
r _{1,2} - min.	0.3 mm
r _{3,4} - min.	0.15 mm
a	7 mm
d _a - min.	19 mm
d _b - min.	19 mm
D _a - max.	28 mm
D _b - max.	29.2 mm
r _a - max.	0.3 mm
r _b - max.	0.15 mm
d _n	22 mm
Basic dynamic load rating - C	3.3 kN
Basic static load rating - C ₀	1.6 kN
Fatigue load limit - P _u	0.067 kN



San Driveshaft Co., Ltd.

Limiting speed for grease lubrication	83000 r/min
Limiting speed for oil lubrication	127000 mm/min
Ball - D_w	3.969 mm
Ball - z	13
G_{ref}	0.2 cm ³
Calculation factor - f_0	7.9
Preload class A - G_A	18 N
Preload class B - G_B	54 N
Preload class C - G_C	108 N
Calculation factor - f	1.05
Calculation factor - f	1
Calculation factor - f_{2A}	1
Calculation factor - f_{2B}	1.05
Calculation factor - f_{2C}	1.09
Calculation factor - f_{HC}	1.01
Preload class A	16 N/micron
Preload class B	25 N/micron
Preload class C	34 N/micron
d_1	21.1 mm
d_2	20.1 mm
D_1	25.9 mm
$r_{1,2}$ min.	0.3 mm
$r_{3,4}$ min.	0.15 mm
d_a min.	19 mm
d_b min.	19 mm
D_a max.	28 mm
D_b max.	29.2 mm
r_a max.	0.3 mm
r_b max.	0.15 mm



San Driveshaft Co., Ltd.

d_n	22 mm
Basic dynamic load rating C	3.32 kN
Basic static load rating C_0	1.56 kN
Fatigue load limit P_u	0.067 kN
Attainable speed for grease lubrication	83000 r/min
Attainable speed for oil-air lubrication	127000 r/min
Ball diameter D_w	3.969 mm
Number of balls z	13
Reference grease quantity G_{ref}	0.2 cm ³
Preload class A G_A	18 N
Static axial stiffness, preload class A	16 N/ μ m
Preload class B G_B	54 N
Static axial stiffness, preload class B	25 N/ μ m
Preload class C G_C	108 N
Static axial stiffness, preload class C	34 N/ μ m
Calculation factor f	1.05
Calculation factor f_1	1
Calculation factor f_{2A}	1
Calculation factor f_{2B}	1.05
Calculation factor f_{2C}	1.09
Calculation factor f_{HC}	1.01
Calculation factor f_0	7.9
Mass bearing	0.014 kg