

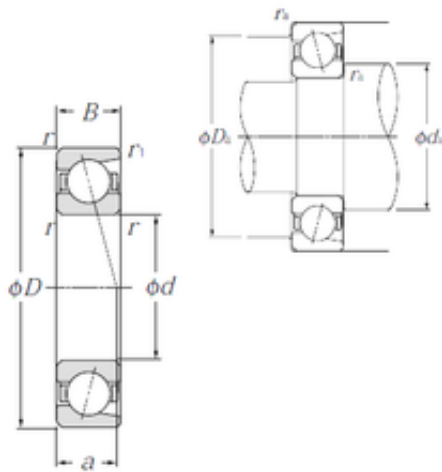

San Driveshaft Co., Ltd.

160 mm x 200 mm x 20 mm NTN 7832C High Reliability Precision Bearings



7832C Bearing 2D drawings and 3D CAD models

Bearing No. 7832C

Size	160x200x20 mm
Bore Diameter	160 mm
Outer Diameter	200 mm
Width	20 mm
d	160 mm
D	200 mm
B	20 mm
C	20 mm
Angle (°)	15 °
a	34 mm
r min.	1,1 mm
r1 min.	0,6 mm
Weight	1,41 Kg
Basic dynamic load rating (C)	62 kN
Basic static load rating (C0)	83,5 kN
(Grease) Lubrication Speed	4 400 r/min
(Oil) Lubrication Speed	5 900 r/min