

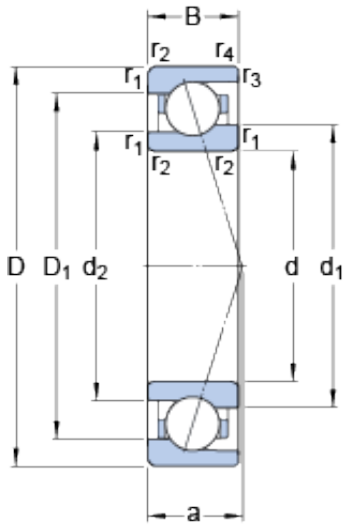

San Driveshaft Co., Ltd.



71905 ACE/P4A Bearing 2D drawings and 3D CAD models

25 mm x 42 mm x 9 mm SKF 71905 ACE/P4A High Accuracy Precision Bearings

Bearing No. 71905 ACE/P4A

Size	42x25x9 mm
Bore Diameter	42 mm
Outer Diameter	25 mm
Width	9 mm
d	25 mm
D	42 mm
B	9 mm
d ₁	30.7 mm
d ₂	29.4 mm
D ₁	36.39 mm
r _{1,2} - min.	0.3 mm
r _{3,4} - min.	0.15 mm
a	12.8 mm
d _a - min.	27 mm
d _b - min.	27 mm
D _a - max.	40 mm
D _b - max.	41.2 mm
r _a - max.	0.3 mm
r _b - max.	0.15 mm
d _n	31.8 mm
Basic dynamic load rating - C	4.9 kN
Basic static load rating - C ₀	2.7 kN
Fatigue load limit - P _u	0.114 kN
Limiting speed for grease	44000 r/min



San Driveshaft Co., Ltd.

Lubrication	
Limiting speed for oil lubrication	68000 mm/min
Ball - D_w	4.762 mm
Ball - z	16
G_{ref}	0.6 cm ³
Calculation factor - e	0.68
Calculation factor - Y_2	0.87
Calculation factor - Y_0	0.38
Calculation factor - X_2	0.41
Calculation factor - Y_1	0.92
Calculation factor - Y_2	1.41
Calculation factor - Y_0	0.76
Calculation factor - X_2	0.67
Preload class A - G_A	45 N
Preload class B - G_B	140 N
Preload class C - G_C	270 N
Calculation factor - f	1.06
Calculation factor - f_1	0.99
Calculation factor - f_{2A}	1
Calculation factor - f_{2B}	1.04
Calculation factor - f_{2C}	1.07
Calculation factor - f_{HC}	1
Preload class A	51 N/micron
Preload class B	77 N/micron
Preload class C	100 N/micron
d_1	30.7 mm
d_2	29.4 mm
D_1	36.39 mm
$r_{1,2}$ min.	0.3 mm



San Driveshaft Co., Ltd.

$r_{3,4}$ min.	0.15 mm
d_a min.	27 mm
d_b min.	27 mm
D_a max.	40 mm
D_b max.	41.2 mm
r_a max.	0.3 mm
r_b max.	0.15 mm
d_n	31.8 mm
Basic dynamic load rating C	4.94 kN
Basic static load rating C_0	2.7 kN
Fatigue load limit P_u	0.114 kN
Attainable speed for grease lubrication	44000 r/min
Attainable speed for oil-air lubrication	68000 r/min
Ball diameter D_w	4.762 mm
Number of balls z	16
Reference grease quantity G_{ref}	0.6 cm ³
Preload class A G_A	45 N
Static axial stiffness, preload class A	51 N/ μ m
Preload class B G_B	140 N
Static axial stiffness, preload class B	77 N/ μ m
Preload class C G_C	270 N
Static axial stiffness, preload class C	100 N/ μ m
Calculation factor f	1.06
Calculation factor f_1	0.99
Calculation factor f_{2A}	1
Calculation factor f_{2B}	1.04
Calculation factor f_{2C}	1.07
Calculation factor f_{HC}	1



San Driveshaft Co., Ltd.

Calculation factor e	0.68
Calculation factor (single, tandem) Y_2	0.87
Calculation factor (single, tandem) Y_0	0.38
Calculation factor (single, tandem) X_2	0.41
Calculation factor (back-to-back, face-to-face) Y_1	0.92
Calculation factor (back-to-back, face-to-face) Y_2	1.41
Calculation factor (back-to-back, face-to-face) Y_0	0.76
Calculation factor (back-to-back, face-to-face) X_2	0.67
Mass bearing	0.04 kg